

Basement waterproofing – earth moist

Waterproof insulation HI 6.1.1 SELF

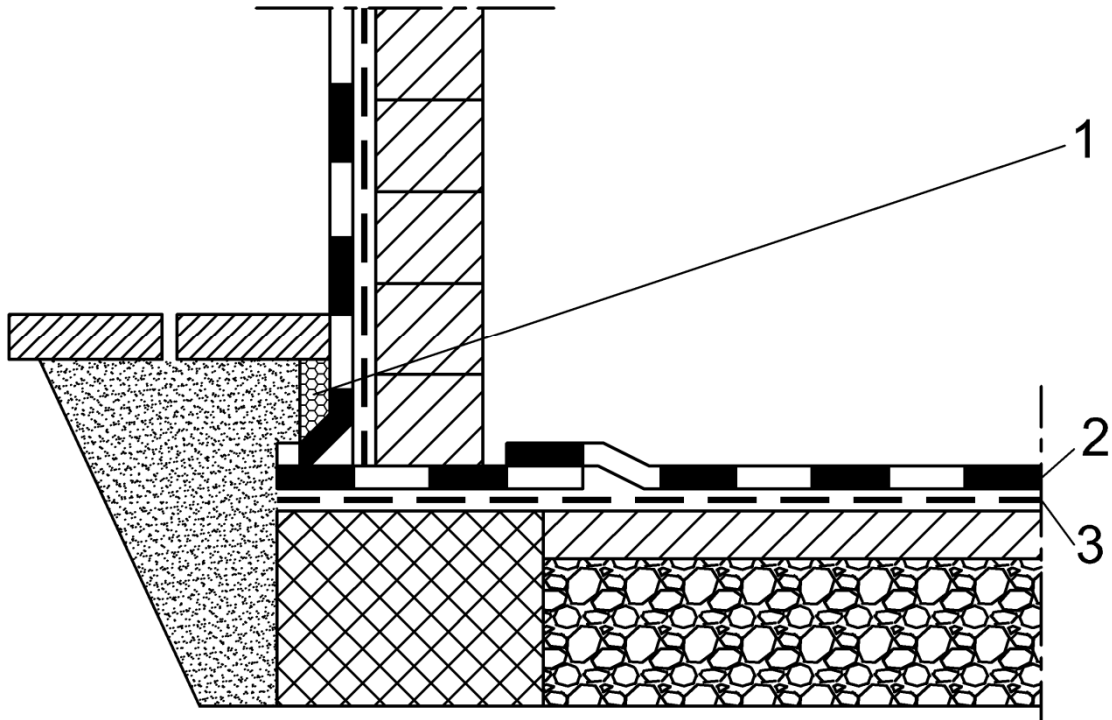

1. **TERMODUR**, according to EN 13163, EU Construction Products Directive 89/106/EEC, thermal insulation is water resistance, also waterproofing protection layer
2. **IZOSELF P3**, bituminous torch-on membrane, according to EN 13969 type T, in socle area min. 30 cm above the ground level
3. **IBITOL**, cold applied asphalt coat - primer