

Basement waterproofing – seepage water (pressure up to 100mm)

Waterproof insulation HI 6.1.2 APP

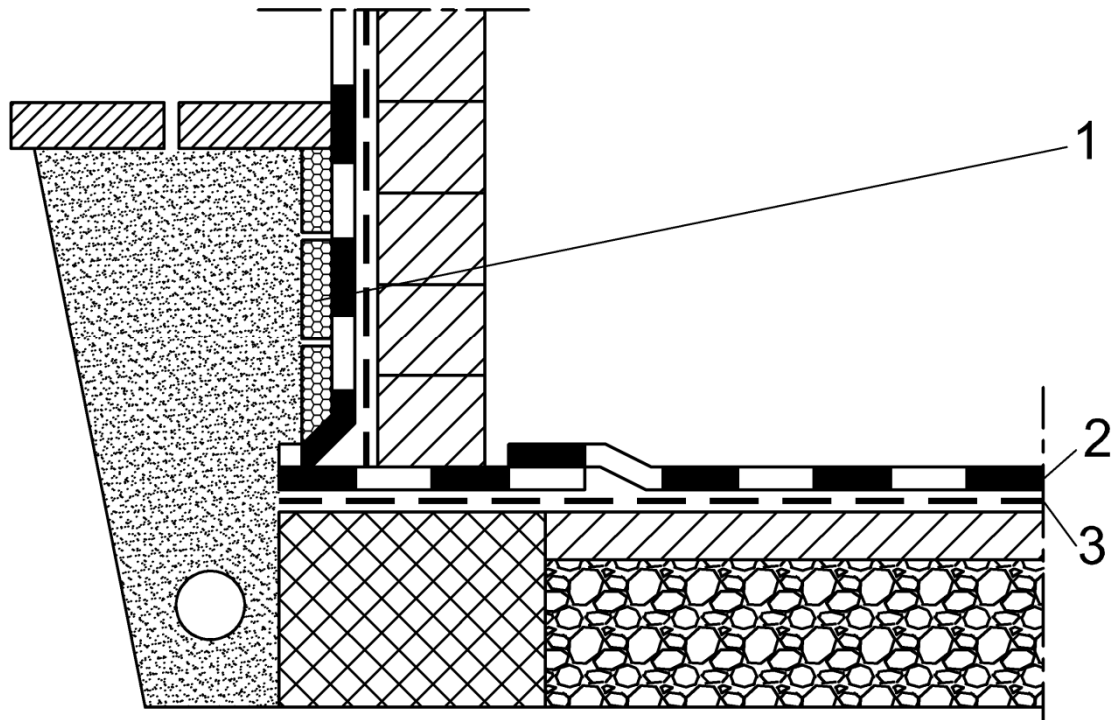

1. **TERMODUR**, according to EN 13163, EU Construction Products Directive 89/106/EEC, thermal insulation is water resistance, also waterproofing protection layer
2. **IZOTEKT T4 PLUS** or **IZOTEKT P4 PLUS**, bituminous torch-on membrane *, according to EN 13969 type T
3. **IBITOL**, cold applied asphalt coat - primer

* in the case of higher pressure or loads in two layers