

## Basement waterproofing – seepage water (pressure up to 100mm)

Waterproof insulation HI 6.1.2 SELF

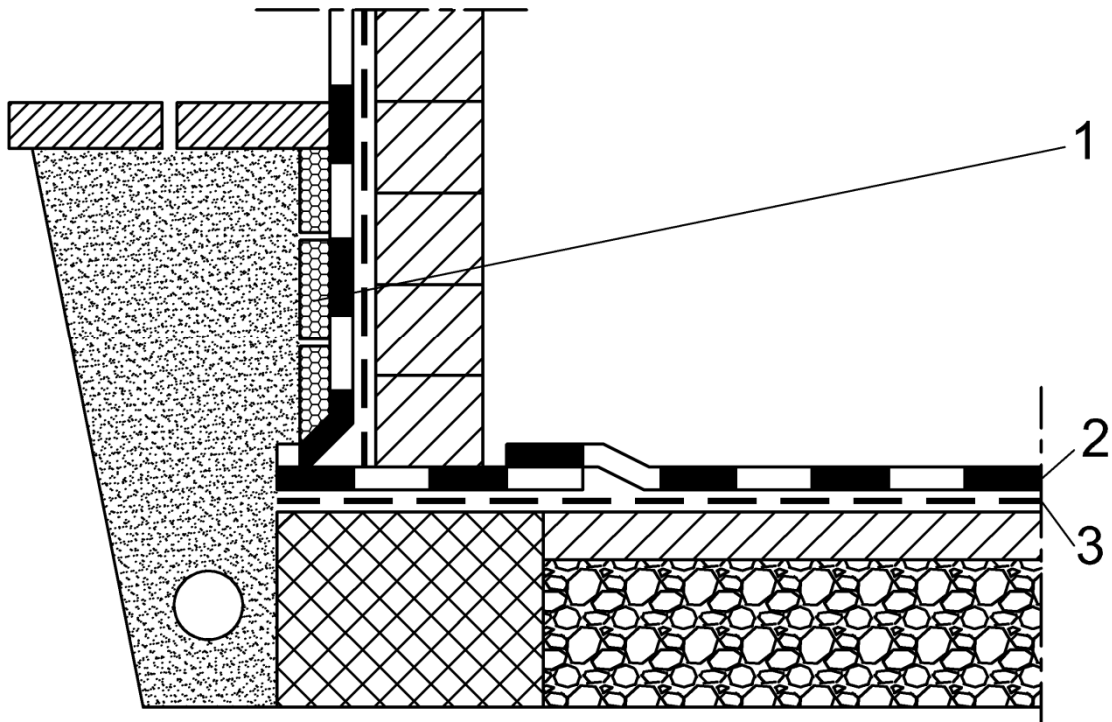

1. **TERMODUR**, according to EN 13163, EU Construction Products Directive 89/106/EEC, thermal insulation is water resistance, also waterproofing protection layer
2. **IZOSELF P3**, bituminous torch-on membrane \*, according to EN 13969 type T, in socle area min. 30 cm above ground level
3. **IBITOL**, cold applied asphalt coat - primer

\* in the case of higher pressure or loads in two layers