

**Basement waterproofing – active water pressure 4m**

Waterproof insulation HI 6.1.3 APP

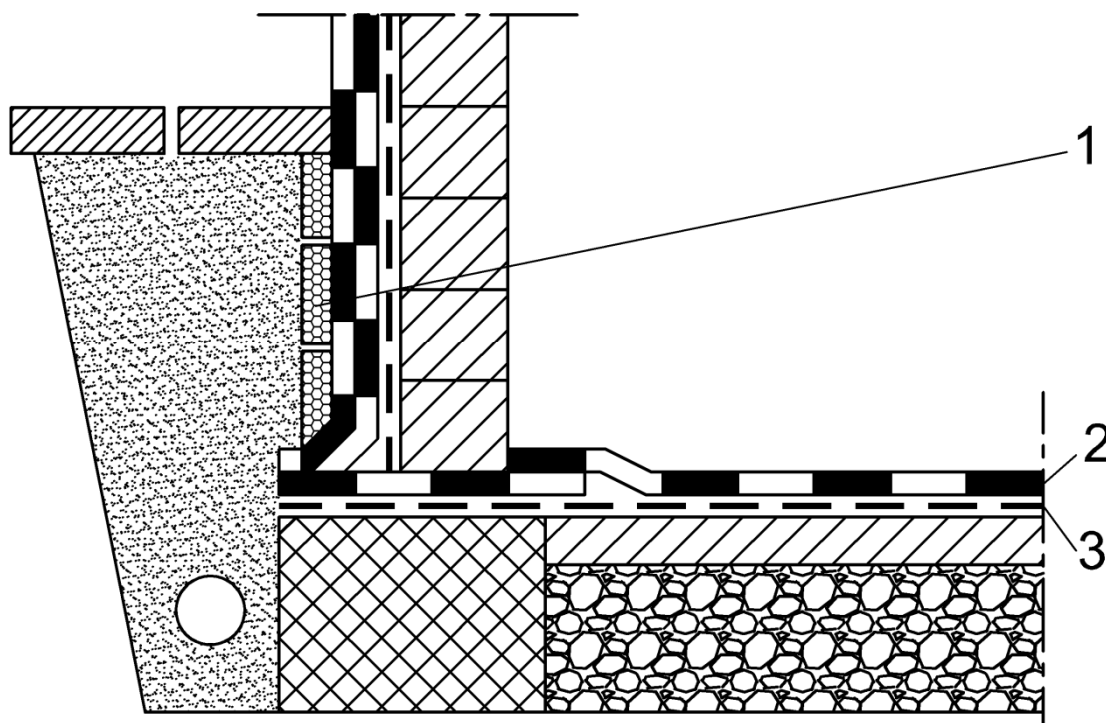

1. **TERMODUR**, according to EN 13163, EU Construction Products Directive 89/106/EEC, thermal insulation is water resistance, also waterproofing protection layer
2. **IZOTEKT T4 PLUS** or **IZOTEKT P4 PLUS** in two layers, bituminous torch-on membrane, according to EN 13969 type T, in socle area min. 30 cm above ground level
3. **IBITOL**, cold applied asphalt coat - primer