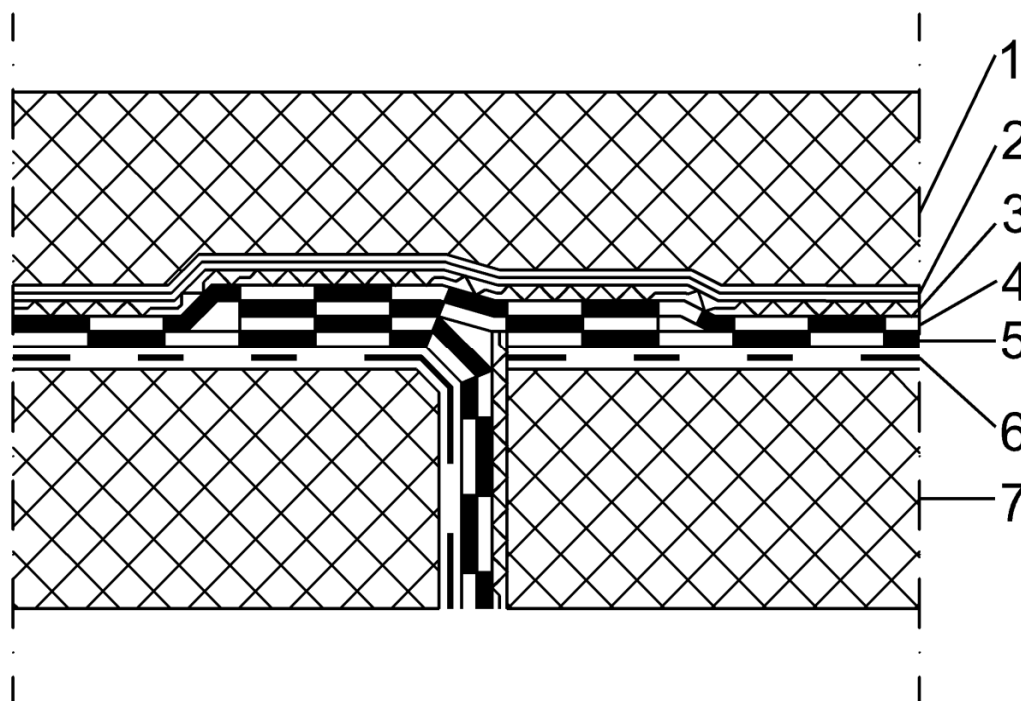

Details of basement waterproofing

Waterproof insulation HI 6.1.8.6

Transition of horizontal to vertical insulation

1. Protecting concrete construction
2. Separating PE sheet
3. Separating sheet (polyester felt 300 g/ m²)
4. Torch applied bituminous membrane
5. Torch applied bituminous membrane
6. **IBITOL**, cold applied asphalt coat - primer
7. Concrete construction