

Trafficable flat roof with expanded polystyrene (EPS)

Flat roof RS 6.3.14 SBS

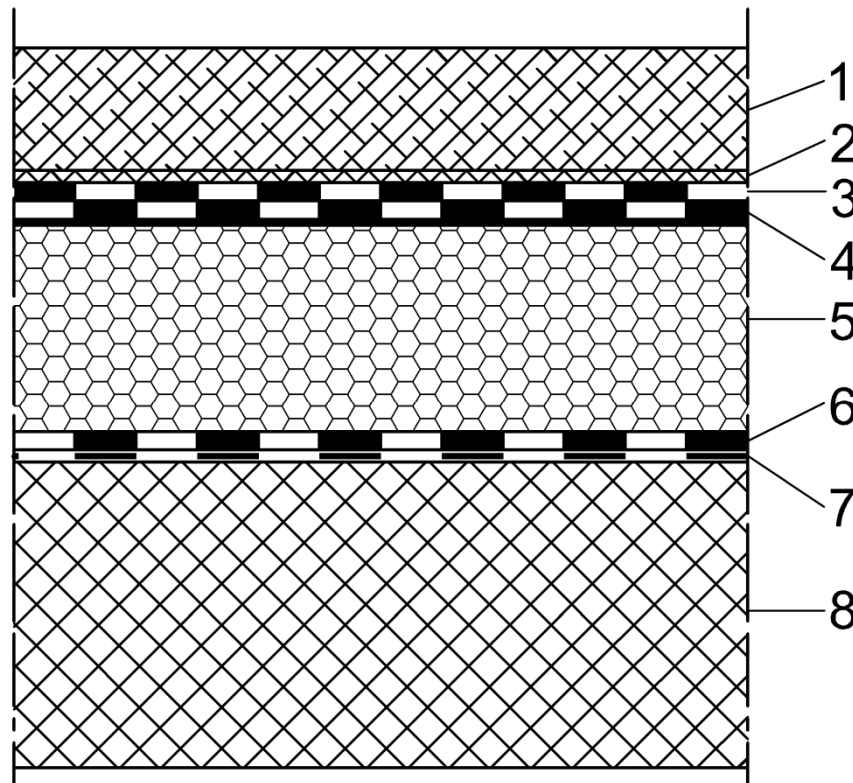

1. Trafficable surface - protecting concrete layer
2. Drainage and separating layer (polyester felt 500 g/m²)
3. **IZOELAST P5 PLUS**, torch applied bituminous membrane, fully torched over lower sheet, according to EN 13707
4. **IZOELAST P4 PLUS** or **IZOELAST T4 PLUS**, torch applied bituminous membrane, partially torched on roof deck, according to EN 13707 *
5. **STIROTEKT L1 (FRAGMAT EPS 200** one side laminated with bituminous cardboard, according to EN 13163)*
6. **BITALBIT AL V4** or **BITALBIT SELF**, vapour barrier bituminous sheet, according to EN 13970
7. **IBITOL**, cold applied asphalt coat - primer
8. Load bearing still reinforced concrete construction (min. slope 2%)

* instead of 4 and 5 we can use **STIROTEKT P3 (FRAGMAT EPS 200** one side laminated with **IZOELAST**)