

Trafficable - inverted - flat roof, with extruded polystyrene (XPS)

Flat roof RS 6.3.15 SELF

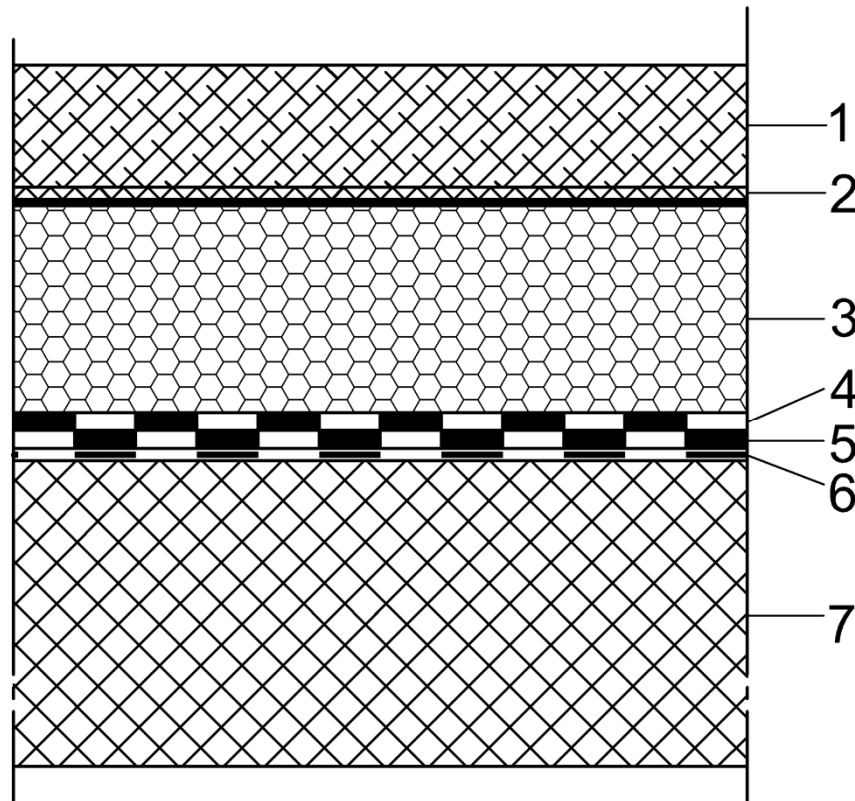

1. Trafficable surface - protecting concrete layer
2. Drainage and separating sheet (polyester felt 500 g/m²)
3. Extruded polystyrene (XPS)
4. **IZOELAST P5 PLUS**, torch applied bituminous membrane, fully torched over lower sheet, according to EN 13707
5. **IZOSELF P3**, self adhesive bituminous membrane, cold bonded over roof deck, according to EN 13707 type T
6. **IBITOL**, cold applied asphalt coat - primer
7. Load bearing still reinforced concrete construction (min. slope 2%)